



Typ / Type : Z 355 E1		Art.-Nr. / Art.-No. : F05-35507	
U	230V (50Hz)	$\Delta p_{fa \text{ min}}$	50 Pa
P_1	0,6 kW	ΔI	10 %
I_N	3.0 A	I_A / I_N	2.5
n	1320 min ⁻¹		IP54
C_{400V}	12 μF		01.024
t_R	40 °C		40.0 kg



Geräusche / Sound levels:

LWAreI A-bewertet bei $V=0,5 \cdot V_{max}$ LWAreI A-weighted at $V=0,5 \cdot V_{max}$	fM [Hz]						
	125	250	500	1K	2K	4K	8K
LWA2 [dB(A)] Gehäuse / casing	47	49	40	39	36	29	26
LWA5 [dB(A)] Ansaugseite / inlet side	50	51	42	46	48	47	37
LWA6 [dB(A)] Ausblasseite / outlet side	60	64	67	67	66	63	54

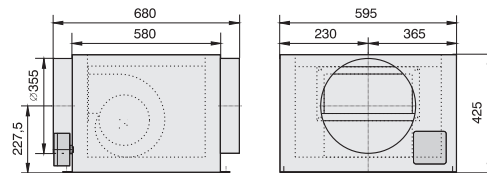
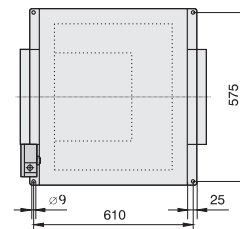

Maße / Dimensions:

(alle Maße in mm / all dimensions in mm)